



STATE OF NORTH CAROLINA  
DEPARTMENT OF TRANSPORTATION

JOSH STEIN  
GOVERNOR

DANIEL H. JOHNSON  
SECRETARY

May 04, 2026

**NOTICE TO PROSPECTIVE BIDDERS**

**Contract Number:** DH00608  
**WBS Number:** 51274  
**County:** Chatham  
**Description:** Grading, Paving, Drainage, Concrete Islands, and Pavement Markings at US 421 and SR 2120 (Ike Brooks Road)  
**Subject:** **Addendum #1**

The following revisions have been made to the project proposal associated with the above referenced project:

- Various line items, quantities and types have changed.
- Please replace plan sheets 001A, 2A-1, 2A-2, 3A-1, 3B-1, 04, 04A, TMP-2, TMP-3, PMP 001A, and PMP 002, with the revised plan sheets.
- Please replace the Proposal Item Sheets for DH00608 in the Proposal.
- The addendum file DH00608.001x file has been updated to the Bid Express site.

For questions, please contact me at (910) 773-8034 or [cgbrown1@ncdot.gov](mailto:cgbrown1@ncdot.gov).

Sincerely,

DocuSigned by:

*Chad G. Brown*

15C686F6ED674C5...

Chad G. Brown

Division Proposal Engineer

cc: File ec: Mr. J. S. Brooke, PE Prospective Bidders Plan Rooms

County: CHATHAM

Line #	Item Number	Sec #	Description	Quantity	Unit Cost	Amount
<b>ROADWAY ITEMS</b>						
0001	0000100000-N	800	MOBILIZATION	Lump Sum	L.S.	
0002	0043000000-N	226	GRADING	Lump Sum	L.S.	
0003	1220000000-E	545	INCIDENTAL STONE BASE	25 TON		
0004	1330000000-E	607	INCIDENTAL MILLING	3,715 SY		
0005	1491000000-E	610	ASPHALT CONC BASE COURSE, TYPE B25.0C	85 TON		
0006	1503000000-E	610	ASPHALT CONC INTERMEDIATE COURSE, TYPE I19.0C	50 TON		
0007	1519000000-E	610	ASPHALT CONC SURFACE COURSE, TYPE S9.5B	370 TON		
0008	1575000000-E	620	ASPHALT BINDER FOR PLANT MIX	28 TON		
0009	2655000000-E	852	5" MONOLITHIC CONCRETE ISLANDS (KEYED IN)	305 SY		
0010	4025000000-E	901	CONTRACTOR FURNISHED, TYPE *** SIGN E	108 SF		
0011	4025000000-E	901	CONTRACTOR FURNISHED, TYPE *** SIGN F	83 SF		
0012	4072000000-E	903	SUPPORTS, 3-LB STEEL U-CHANNEL	369 LF		
0013	4102000000-N	904	SIGN ERECTION, TYPE E	10 EA		
0014	4108000000-N	904	SIGN ERECTION, TYPE F	4 EA		
0015	4400000000-E	1110	WORK ZONE SIGNS (STATIONARY)	96 SF		
0016	4405000000-E	1110	WORK ZONE SIGNS (PORTABLE)	245 SF		
0017	4410000000-E	1110	WORK ZONE SIGNS (BARRICADE MOUNTED)	36 SF		

County: CHATHAM

Line #	Item Number	Sec #	Description	Quantity	Unit Cost	Amount
0018	4415000000-N	1115	FLASHING ARROW BOARD	4 EA		
0019	4420000000-N	1120	PORTABLE CHANGEABLE MESSAGE SIGN	4 EA		
0020	4430000000-N	1130	DRUMS	50 EA		
0021	4435000000-N	1135	CONES	25 EA		
0022	4445000000-E	1145	BARRICADES (TYPE III)	25 LF		
0023	4455000000-N	1150	FLAGGER	40 DAY		
0024	4480000000-N	1165	TMA	2 EA		
0025	4510000000-N	1190	LAW ENFORCEMENT	40 HR		
0026	4688000000-E	1205	THERMOPLASTIC PAVEMENT MARKING LINES (6", 90 MILS)	2,436 LF		
0027	4700000000-E	1205	THERMOPLASTIC PAVEMENT MARKING LINES (12", 90 MILS)	1,120 LF		
0028	4709000000-E	1205	THERMOPLASTIC PAVEMENT MARKING LINES (24", 90 MILS)	95 LF		
0029	4725000000-E	1205	THERMOPLASTIC PAVEMENT MARKING SYMBOL (90 MILS)	6 EA		
0030	4895000000-N	SP	GENERIC PAVEMENT MARKING ITEM POLYCARBONATE H-SHAPED MARKERS	52 EA		
0031	6036000000-E	1631	MATTING FOR EROSION CONTROL	705 SY		
0032	6071002000-E	1642	FLOCCULANT	10 LB		
0033	6071010000-E	1642	WATTLE	260 LF		
0034	6084000000-E	1660	SEEDING & MULCHING	0.45 ACR		

County: CHATHAM

Line #	Item Number	Sec #	Description	Quantity	Unit Cost	Amount
0035	6090000000-E	1661	SEED FOR REPAIR SEEDING	50 LB		
0036	6093000000-E	1661	FERTILIZER FOR REPAIR SEEDING	0.25 TON		
0037	6117500000-N	SP	CONCRETE WASHOUT STRUCTURE	1 EA		

1057/May04/Q10456.7/D146752612000/E37

Total Amount Of Bid For Entire Project :

INDEX OF SHEETS

SHEET NUMBER	SHEET
1	TITLE SHEET
1A	INDEX OF SHEETS, GENERAL NOTES, AND STANDARD DRAWINGS
1B	CONVENTIONAL SYMBOLS
2A-1 THRU 2A-2	PAVEMENT SCHEDULE AND TYPICAL SECTIONS
3A-1	SUMMARY OF QUANTITIES
3B-1	ROADWAY SUMMARIES
4 THRU 4A	PLAN SHEETS
5-6	PROFILE SHEETS
TMP-1 THRU TMP- 3	TRAFFIC MANAGEMENT PLANS
PMP-1 THRU PMP-2	PAVEMENT MARKING PLANS
EC-1 THRU EC-8	EROSION CONTROL PLANS
SIGN-1 THRU SIGN-4	SIGNING PLANS
X-01	CROSS-SECTION SUMMARY SHEET
X-02 THRU X- 07	CROSS-SECTIONS

GENERAL NOTES

GRADING AND SURFACING OR RESURFACING AND WIDENING:

THE GRADE LINES SHOWN DENOTE THE FINISHED ELEVATION OF THE PROPOSED SURFACING AT GRADE POINTS SHOWN ON THE TYPICAL SECTIONS. WHERE NO GRADE LINES ARE SHOWN, THE PROFILES SHOWN DENOTE THE TOP ELEVATION OF THE EXISTING PAVEMENT ALONG THE CENTER LINE OF SURVEY ON WHICH THE PROPOSED RESURFACING WILL BE PLACED. GRADE LINES MAY BE ADJUSTED BY THE ENGINEER IN ORDER TO SECURE THE PROPER TIE-IN.

CLEARING

CLEARING ON THIS PROJECT SHALL BE PERFORMED TO THE LIMITS ESTABLISHED BY METHOD III.

SHOULDER CONSTRUCTION:

ASPHALT, EARTH, AND CONCRETE SHOULDER CONSTRUCTION ON THE HIGH SIDE OF SUPERELEVATED CURVES SHALL BE IN ACCORDANCE WITH STD. NO. 560.01.

UTILITIES

ANY RELOCATION OF EXISTING UTILITIES WILL BE ACCOMPLISHED BY OTHERS PRIOR TO THE DATE OF AVAILABILITY.

2024 ROADWAY ENGLISH STANDARD DRAWINGS

The following Roadway Standards as appear in "Roadway Standard Drawings" Highway Design Branch - N. C. Department of Transportation - Raleigh, N. C., Dated January 2024 are applicable to this project and by reference hereby are considered a part of these plans:

STD.NO.	TITLE
200.03	Method of Clearing - Method III
225.01	Guide for Grading Subgrade - Interstate and Freeway
225.02	Guide for Grading Subgrade - Secondary and Local
852.01	Concrete Islands

SS6208N

001A



Prepared in the Office of:  
**DIVISION OF HIGHWAYS**  
**DIVISION 8 - DDC**  
**121 DOT Drive**  
**Carthage, 28327**

DocuSigned by:  
**Greg Davis**  
3304785F078F4A8...

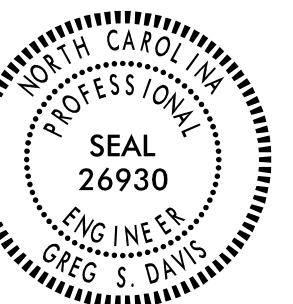

04/30/2026

0 100

**50**  
**Feet**

DOCUMENT NOT CONSIDERED FINAL  
UNLESS ALL SIGNATURES COMPLETED

STATE OF NORTH CAROLINA  
DIVISION OF HIGHWAYS



DIVISION 8 DDC

8/17/99

PRELIMINARY PAVEMENT SCHEDULE

C1	PROP. APPROX. 1.5" ASPHALT CONCRETE SURFACE COURSE, TYPE S9.5C, AT AN AVERAGE RATE OF 168 LBS. PER SQ. YD.
C2	PROP. APPROX. 3" ASPHALT CONCRETE SURFACE COURSE, TYPE S9.5C, AT AN AVERAGE RATE OF 168 LBS. PER SQ. YD. PER 1 1/2" DEPTH. TO BE PLACED IN TWO LAYERS.
C3	PROP. VAR. DEPTH ASPHALT CONCRETE SURFACE COURSE, TYPE S9.5C, AT AN AVERAGE RATE OF 112 LBS. PER SQ. YD. PER 1" DEPTH. TO BE PLACED IN LAYERS NOT TO EXCEED 1.5" IN DEPTH.
D1	PROP. APPROX. 4" ASPHALT CONCRETE INTERMEDIATE COURSE, TYPE I19.0C, AT AN AVERAGE RATE OF 456 LBS. PER SQ. YD.
D2	PROP. VAR. DEPTH ASPHALT CONCRETE INTERMEDIATE COURSE, TYPE I19.0C, AT AN AVERAGE RATE OF 114 LBS. PER SQ. YD. PER 1" DEPTH, TO BE PLACED IN LAYERS NOT LESS THAN 2.5" IN DEPTH OR GREATER THAN 4" IN DEPTH.
E1	PROP. APPROX. 4" ASPHALT CONCRETE BASE COURSE, TYPE B25.0C, AT AN AVERAGE RATE OF 456 LBS. PER SQ. YD.
R1	5" MONOLITHIC CONCRETE ISLAND (KEYED IN)
T	EARTH MATERIAL.
U	EXISTING PAVEMENT.
V	1.5" MILLING (TO BE PAID AS INCIDENTAL MILLING)
W	WEDGING

NOTE: PAVEMENT EDGE SLOPES ARE 1:1 UNLESS SHOWN OTHERWISE

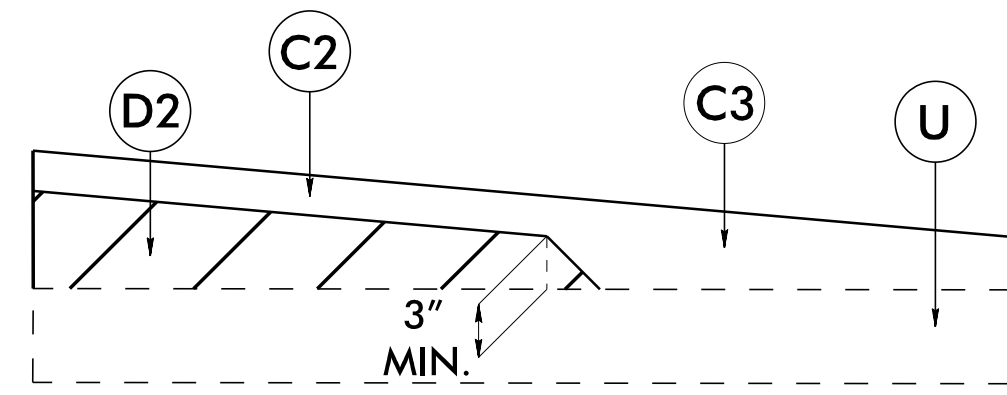

W Wedging Detail For Resurfacing

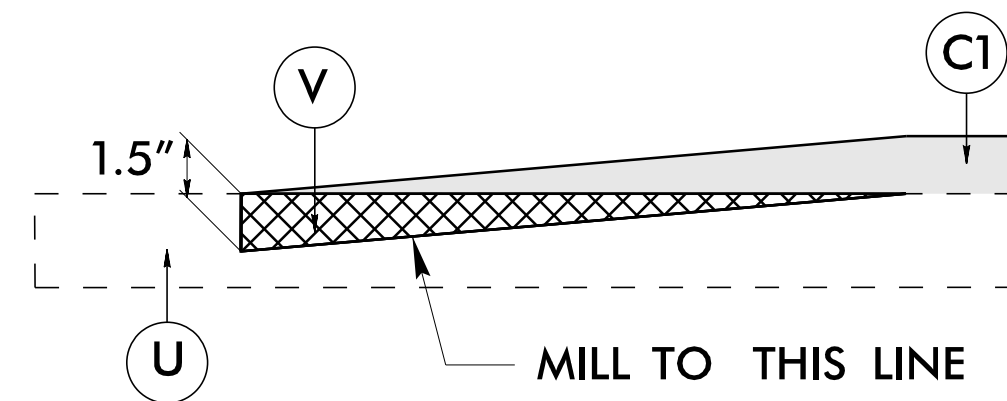

DETAIL OF INCIDENTAL MILLING PAVEMENT TIE-IN

DETAIL A  
DETAIL SHOWING METHOD OF SAWCUT

NOTE:  
WHERE REQUIRED TO SAWCUT EXISTING PAVEMENT TO INSTALL FULL DEPTH PAVEMENT, MILL 2' BEYOND SAWCUT LOCATION PRIOR TO SAWCUTTING THE EXISTING PAVEMENT AND INSTALLATION OF NEW PAVEMENT.

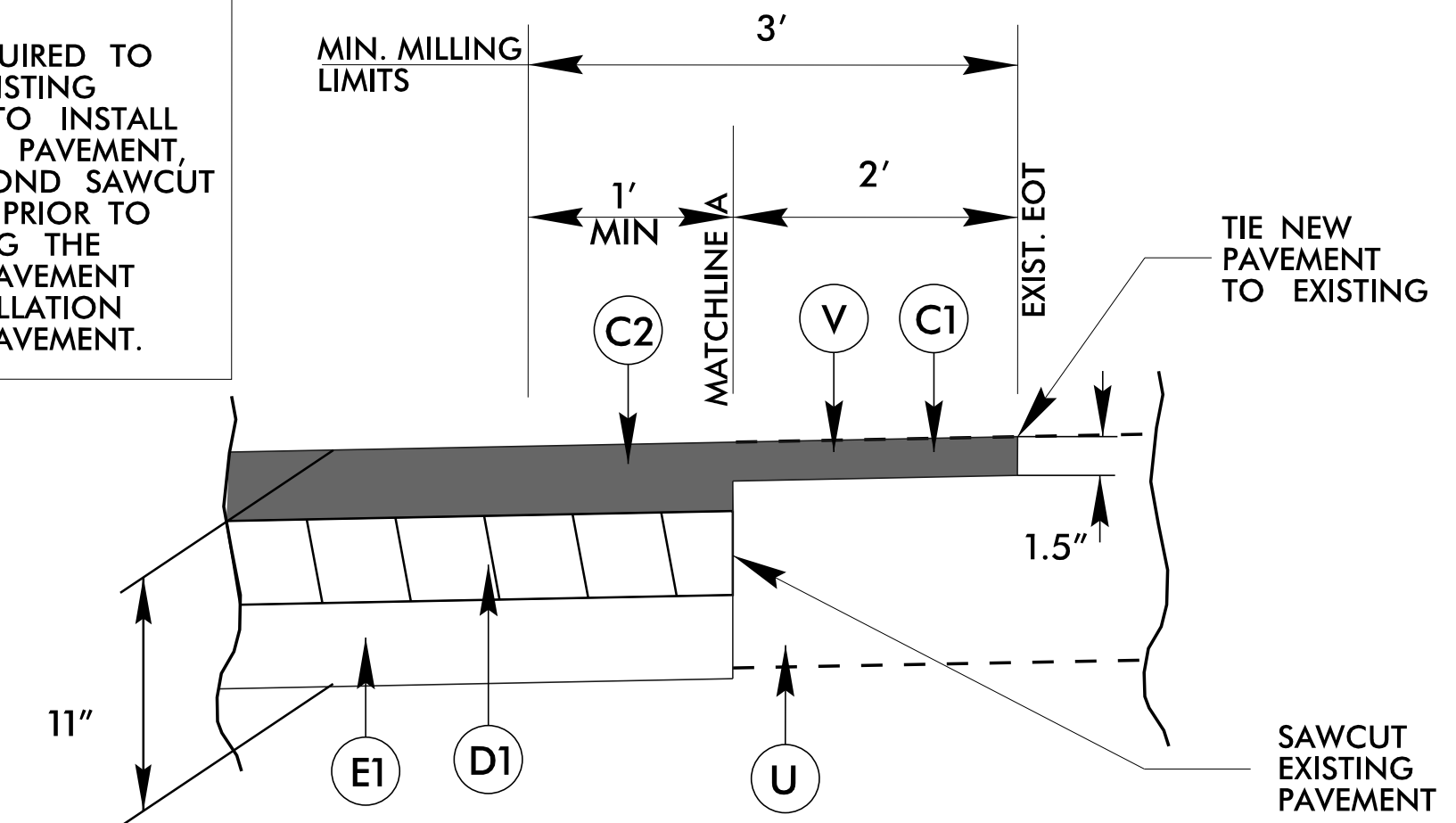

-L- (US 421)

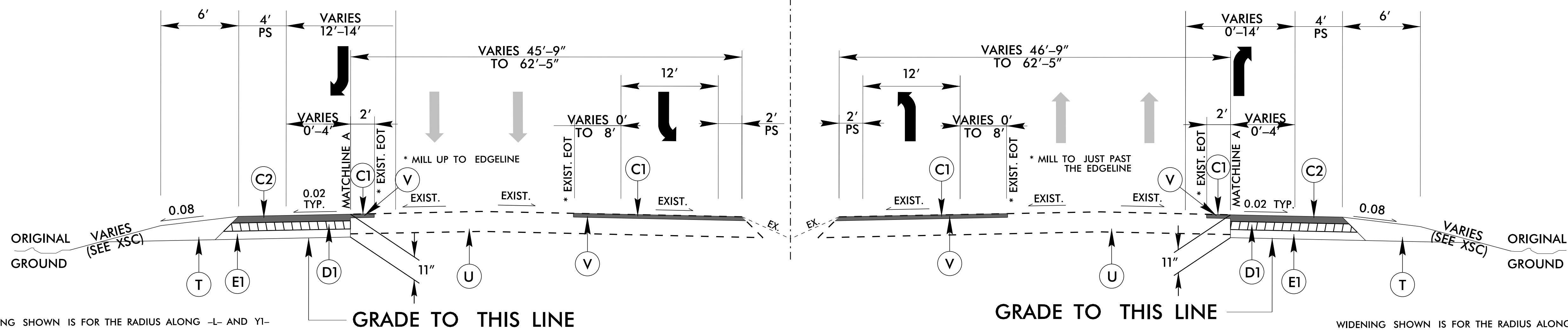

WIDENING SHOWN IS FOR THE RADIUS ALONG -L- AND Y1-

GRADE TO THIS LINE

GRADE TO THIS LINE

WIDENING SHOWN IS FOR THE RADIUS ALONG -L- AND Y1-

TYPICAL SECTION NO. 1

-L- STA. 12 + 83.23 TO STA. 15 + 16.51  
 -L- STA. 16 + 96.07 TO STA. 19 + 19.02

SS-6208N

2A-1



Prepared in the Office of:  
**DIVISION OF HIGHWAYS**  
 DIVISION 8 - DDC  
 121 DOT Drive  
 Carthage, 28327  
 PHONE NUMBER  
 (910)773-8000

DIVISION DESIGN & CONSTRUCT ENGINEER

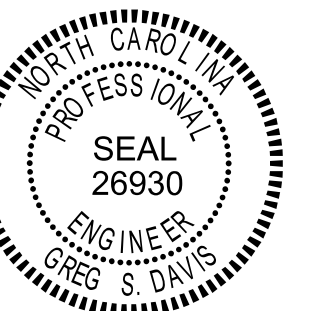

DocuSigned by:  
 Greg Davis  
 3304785F078F48...

04/30/2026

0 60

30 Feet

STATE OF NORTH CAROLINA  
DIVISION OF HIGHWAYS



DIVISION 8 DDC

8/17/99

Prepared in the Office of  
**DIVISION OF HIGHWAYS**  
DIVISION 8 - DDC  
121 DOT Drive  
Carthage, 28327  
PHONE NUMBER  
(910)773-8000  
DIVISION DESIGN & CONSTRUCT ENGINEER

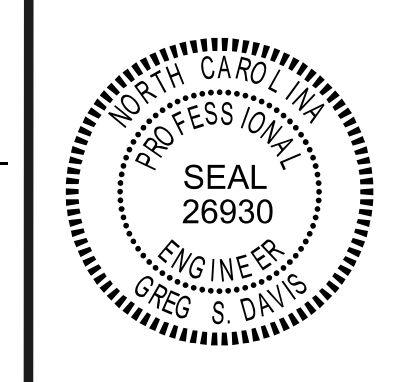

DocuSigned by:  
Greg Davis  
3304786FD78F4A8...  
04/30/2026

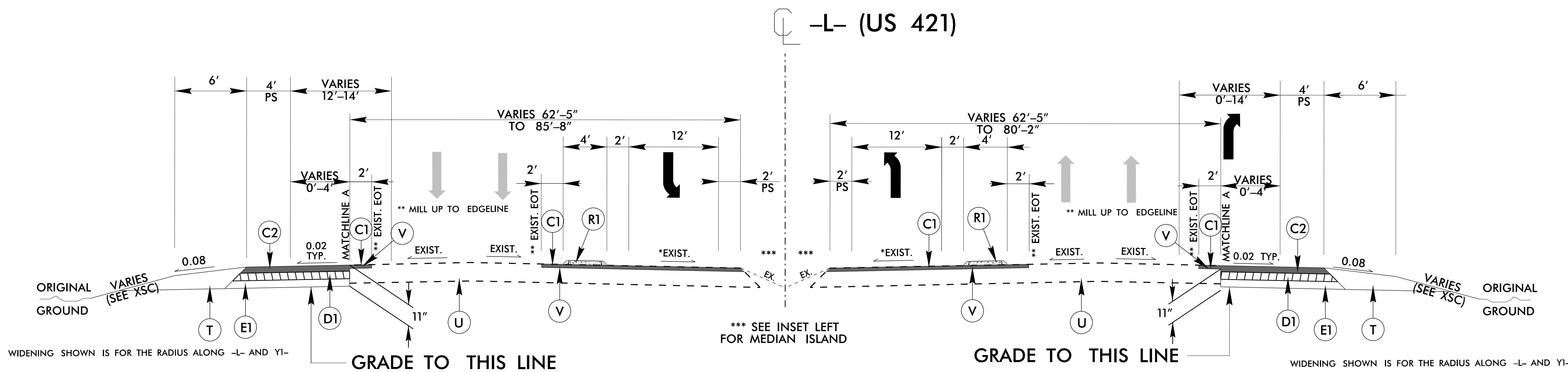

**TYPICAL SECTION NO. 2**  
-L- STA. 15+16.51 TO STA. 16+96.07

\*NOTE: PAVE TO DRAIN TO GRASS MEDIAN

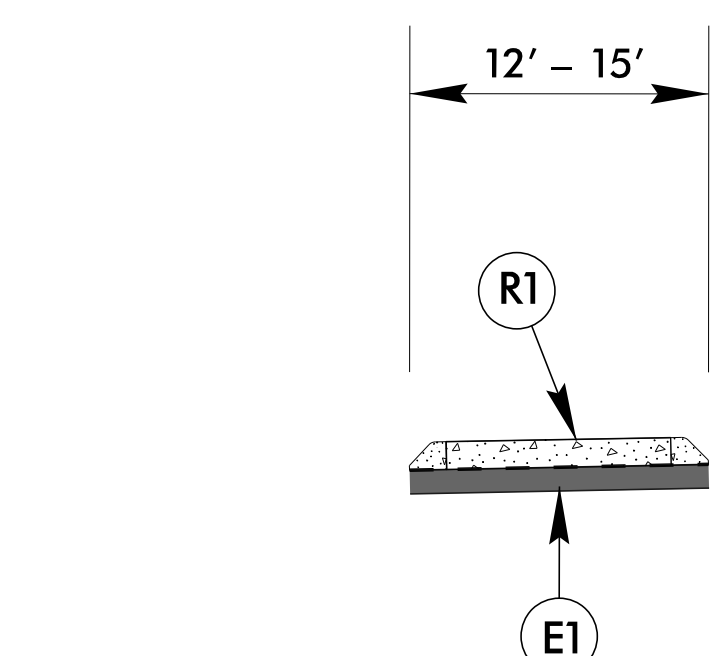

**INSET FOR MEDIAN ISLAND**  
-L- STA. 15+16.51 TO STA. 15+67.53 LT  
-L- STA. 16+53.14 TO STA. 16+95.84 RT

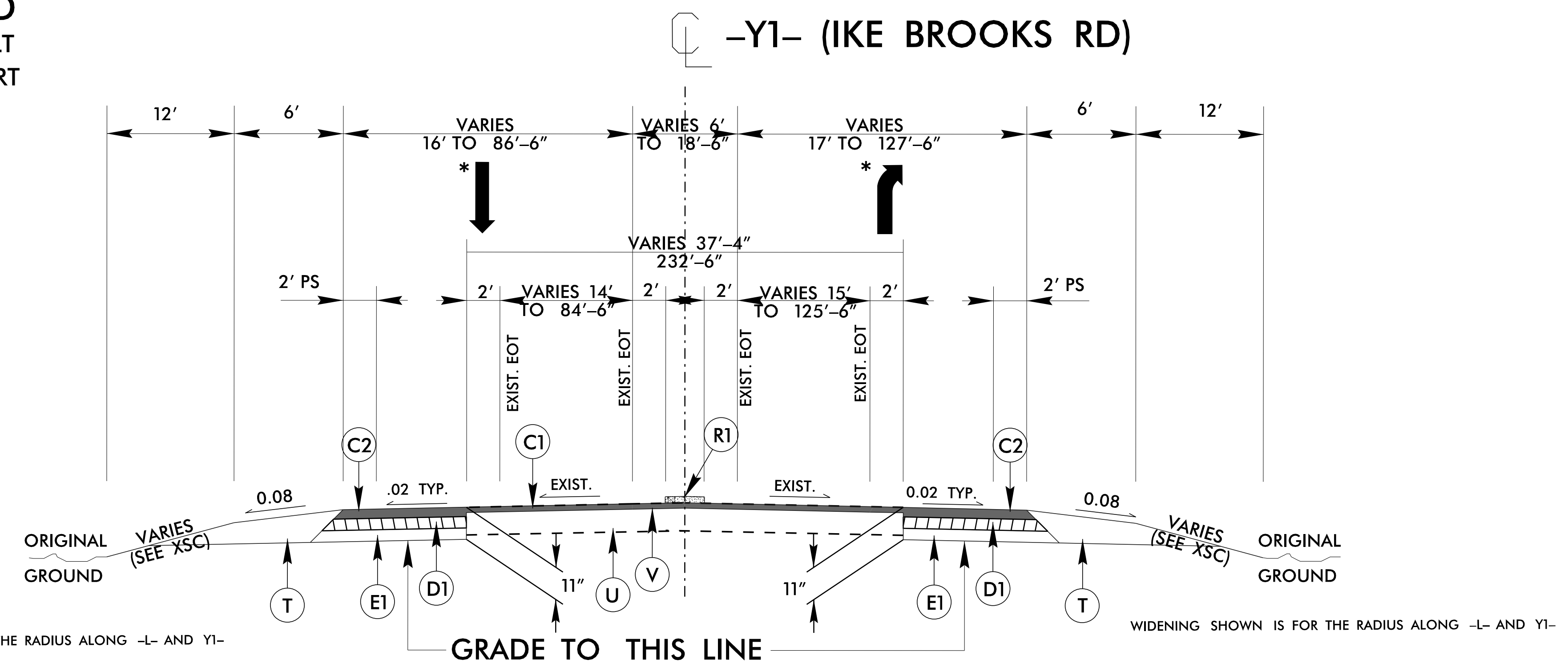

**TYPICAL SECTION NO. 3**  
-Y1- STA. 11+23.61 TO STA. 11+94.00  
-Y1- STA. 12+51.05 TO STA. 14+28.68

\*ARROWS MIRROR FOR  
-Y1- STA. 12+51.05 TO STA. 14+28.68

PAVEMENT SCHEDULE	
C1	1.5" S9.5C
C2	3" S9.5C
D1	4" I19.0C
E1	4" B25.0C
R1	5" CONC. ISLAND KEYED IN
T	EARTH MATERIAL.
U	EXIST. PAVEMENT
V	1.5" MILLING

NOTE: PAVEMENT EDGE SLOPES ARE 1:1 UNLESS SHOWN OTHERWISE

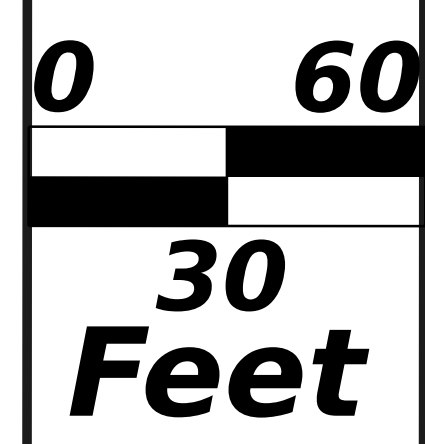

PROJECT NO.	SHEET NO.	TOTAL NO.
SS-6208N	3A-1	

### SUMMARY OF QUANTITIES

PROJECT NO	COUNTY	MAP NO	ROUTE	DESCRIPTION	TYP NO	LANES	LANE TYPE	LENGTH	WIDTH	0043000000-N	1220000000-E	1330000000-E	1491000000-E	1503000000-E	1523000000-E	1575000000-E	2655000000-E	4025000000-E		4072000000-E	4102000000-N	4108000000-N	6036000000-E	6071002000-E	6071010000-E	6084000000-E	6090000000-E	6093000000-E	6117500000-N
										GRADING	INCIDENTAL STONE BASE	INCIDENTAL MILLING	BASE COURSE, B25.0C	INTERMEDIATE COURSE, I19.0C	SURFACE COURSE, S9.5C	ASPHALT BINDER FOR PLANT MIX	5" MONOLITHIC CONCRETE ISLANDS(KEYED-IN)	CONTRACTOR FURNISHED, TYPE 'E' SIGN	CONTRACTOR FURNISHED, TYPE 'F' SIGN	SUPPORTS, 3-LB STEEL U-CHANNEL STEEL	SIGN ERECTION, TYPE E	SIGN ERECTION, TYPE F	MATTING (EROSION CONTROL)	FLOCCULANT	WATTLE	SEED & MULCHING	SEED FOR REPAIR SEEDING	FERTILIZER FOR REPAIR SEEDING	CONCRETE WASHOUT STRUCTURE
									L	TONS	SY	TONS	TONS	TONS	TONS	SY	SF	SF	LF	EA	EA	SY	LB	LF	AC	LB	TON	EA	
SS-6208N	Chatham	1	US-421 N	INTERSECTION OF US 421 AT SR 2120 (IKE BROOKS ROAD)	1,2,3	4	MD	0.120	102	1	25	3,715	85	50	370	28	305	108	83	369	10	4	705	10	260	0.45	50	0.25	1
<b>TOTAL FOR MAP NO. 1</b>									1	25	3,715	85	50	370	28	305	108	83	369	10	4	705	10	260	0.45	50	0.25	1	
<b>TOTAL FOR PROJ NO. SS-6208N</b>									1	25	3,715	85	50	370	28	305	108	83	369	10	4	705	10	260	0.45	50	0.25	1	
<b>GRAND TOTAL</b>									1	25	3,715	85	50	370	28	305	108	83	369	10	4	705	10	260	0.45	50	0.25	1	

### THERMOPLASTIC AND PAINT QUANTITIES

PROJECT NO	COUNTY	MAP NO	ROUTE	DESCRIPTION	TYP NO	LANES	LANE TYPE	LENGTH	WIDTH	4400000000-E	4405000000-E	4410000000-E	4415000000-N	4420000000-N	4430000000-N	4435000000-N	4445000000-E	4455000000-N	4480000000-N	4510000000-N	4688000000-E		4700000000-E		4709000000-E	4725000000-E		4895000000-N	
										WORK ZONE SIGNS (STATIONARY)	WORK ZONE SIGNS (PORTABLE)	BARRICADE MOUNTED WORK ZONE SIGN	FLASHING ARROW BOARD	PORTABLE CHANGEABLE MESSAGE SIGN	DRUMS	CONES	TYPE III BARRICADE	FLAGGER	TMA	LAW ENFORCEMENT	6" X 90 M WHITE THERMO	6" X 90 M YELLOW THERMO	12" X 90 M WHITE THERMO	12" X 90 M YELLOW THERMO	24" X 90 M WHITE THERMO	THERMO LT ARROW 90 M	THERMO RT ARROW 90 M	GENERIC PAVEMENT MARKING ITEM POLYCARBONATE H-SHAPED MARKERS C&R	GENERIC PAVEMENT MARKING ITEM POLYCARBONATE H-SHAPED MARKERS Y&Y
									SF	SF	SF	EA	EA	EA	EA	LF	DAY	EA	HR	LF	LF	LF	LF	LF	EA	EA	EA	EA	
SS-6208N	Chatham	1	US-421 N	INTERSECTION OF US 421 AT SR 2120 (IKE BROOKS ROAD)	1,2,3	4	MD	0.12	102	96	245	36	4	4	50	25	25	40	2	40	953	1,483	1,070	50	95	4	2	46	6
<b>TOTAL FOR MAP NO. 1</b>									96	245	36	4	4	50	25	25	40	2	40	953	1,483	1,070	50	95	4	2	46	6	
<b>TOTAL FOR PROJ NO. SS-6208N</b>									96	245	36	4	4	50	25	25	40	2	40	953	1,483	1,070	50	95	4	2	46	6	
<b>GRAND TOTAL</b>									96	245	36	4	4	50	25	25	40	2	40	953	1,483	1,070	50	95	4	2	46	6	



CUR DATA -L-  
 P/c 13+82.03  
 $\Delta c = 03^{\circ}06'54.8''$  (LT)  
 $D = 00^{\circ}29'54.6''$   
 $Lc = 624.93$   
 $Tc = 312.54$   
 $R = 11,493.91$   
 SE = EXIST.

SS-6208N

04

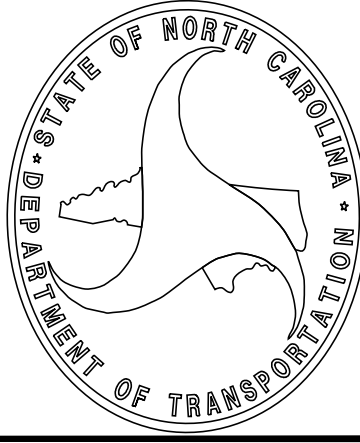

Prepared in the Office of:  
**DIVISION OF HIGHWAYS**  
**DIVISION 8 - DDC**  
 121 DOT Drive  
 Carthage, 28327  
 PHONE NUMBER  
 (910)773-8000

DIVISION DESIGN &  
 CONSTRUCT ENGINEER

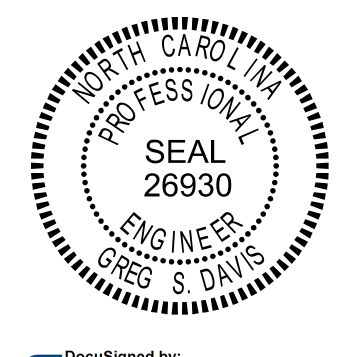

DocuSigned by:  
 Greg Davis  
 3304785FD78F4A8

04/30/2026

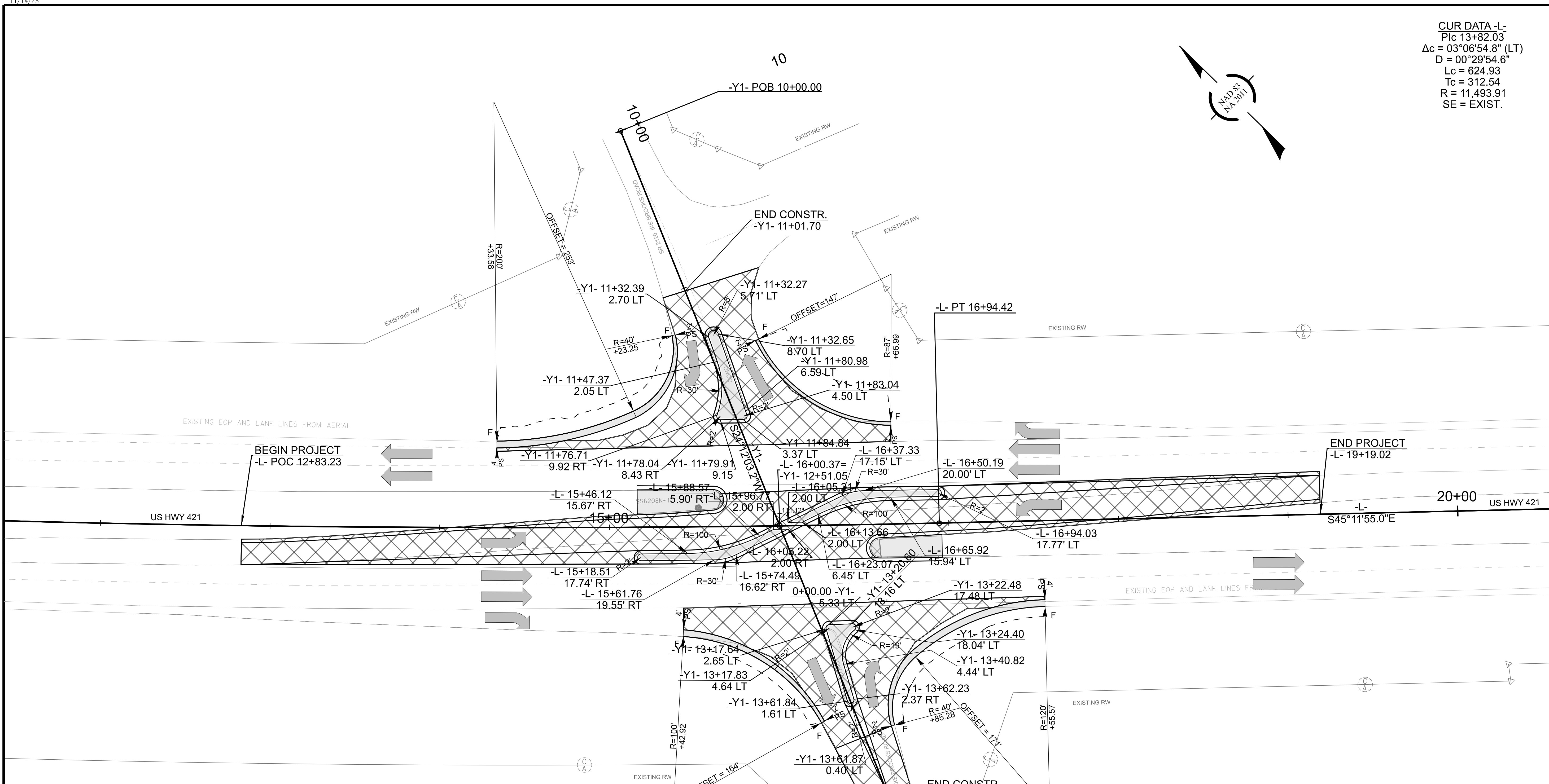

**DATUM DESCRIPTION**

THE LOCALIZED COORDINATE SYSTEM DEVELOPED FOR THIS PROJECT IS BASED ON THE STATE PLANE COORDINATES ESTABLISHED BY NCDOT FOR MONUMENT "SS6208N-1" WITH NAD 83/NA 2011 STATE PLANE GRID COORDINATES OF NORTHING: 692,974.4723(ft) EASTING: 1,883,199.0765(ft) ELEVATION: 537.32(ft) THE AVERAGE COMBINED GRID FACTOR USED ON THIS PROJECT (GROUND TO GRID) IS: 0.999876201328 THE N.C. LAMBERT GRID BEARING AND LOCALIZED HORIZONTAL GROUND DISTANCE FROM "SS6208N-1" TO -L- STATION 10+00.00 IS N 44-21'48.0" W 552.32(ft) ALL LINEAR DIMENSIONS ARE LOCALIZED HORIZONTAL DISTANCES VERTICAL DATUM USED IS NAVD 88

1.5" MILLING AND OVERLAY

FOR -L- PROFILE, SEE SHEET 05  
 FOR -Y1- PROFILE, SEE SHEET 06

0 60

30 Feet

CUR DATA -L-  
P/c 13+82.03  
 $\Delta c = 03^{\circ}06'54.8''$  (LT)  
D =  $00^{\circ}29'54.6''$   
Lc = 624.93  
Tc = 312.54  
R = 11,493.91  
SE = EXIST.

SS-6208N

04A

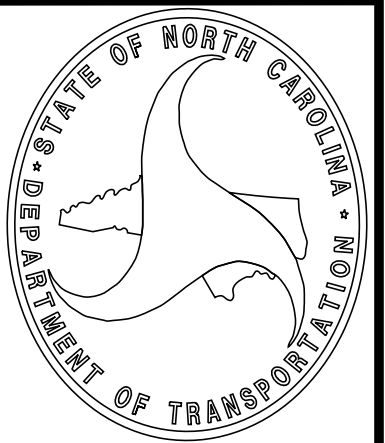

Prepared in the Office of:  
**DIVISION OF HIGHWAYS**  
**DIVISION 8 - DDC**  
121 DOT Drive  
Carthage, 28327  
PHONE NUMBER  
(910)773-8000

DIVISION DESIGN &  
CONSTRUCT ENGINEER

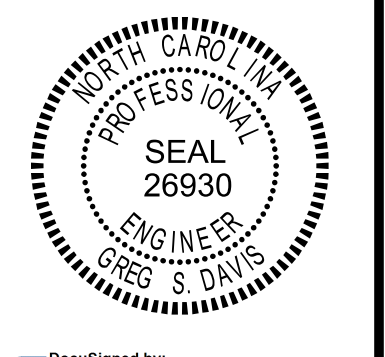

Drawn/Checked by:  
Greg Davis

3304785FD/8F4A8...

04/30/2026

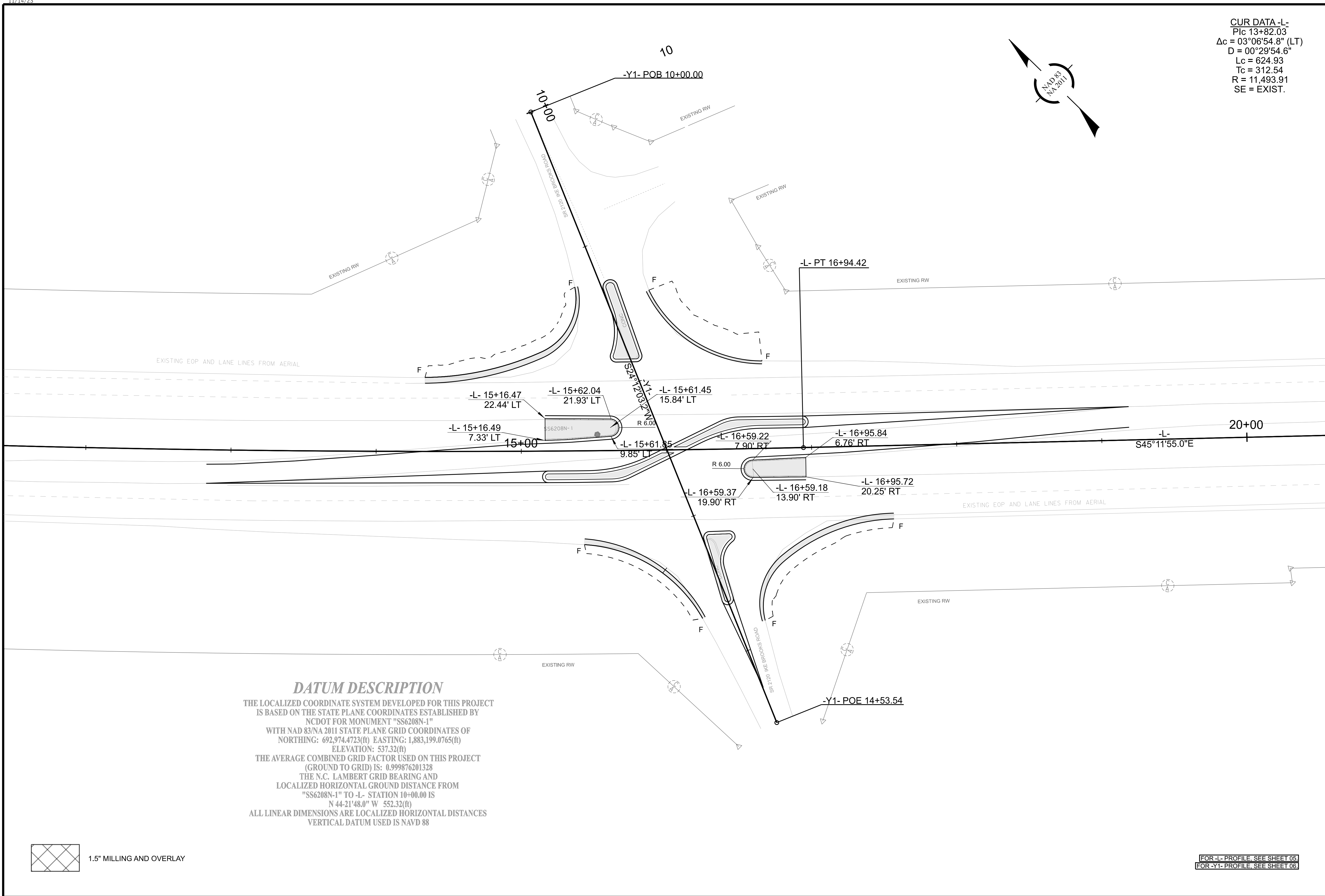

**DATUM DESCRIPTION**

THE LOCALIZED COORDINATE SYSTEM DEVELOPED FOR THIS PROJECT IS BASED ON THE STATE PLANE COORDINATES ESTABLISHED BY NCDOT FOR MONUMENT "SS6208N-1" WITH NAD 83/NA 2011 STATE PLANE GRID COORDINATES OF NORTHING: 692,974.4723(ft) EASTING: 1,883,199.0765(ft) ELEVATION: 537.32(ft) THE AVERAGE COMBINED GRID FACTOR USED ON THIS PROJECT (GROUND TO GRID) IS: 0.999876201328 THE N.C. LAMBERT GRID BEARING AND LOCALIZED HORIZONTAL GROUND DISTANCE FROM "SS6208N-1" TO -L- STATION 10+00.00 IS N 44-21'48.0" W 552.32(ft) ALL LINEAR DIMENSIONS ARE LOCALIZED HORIZONTAL DISTANCES VERTICAL DATUM USED IS NAVD 88



1.5" MILLING AND OVERLAY

0 60

30 Feet

FOR -L- PROFILE, SEE SHEET 05.  
FOR -Y1- PROFILE, SEE SHEET 06.

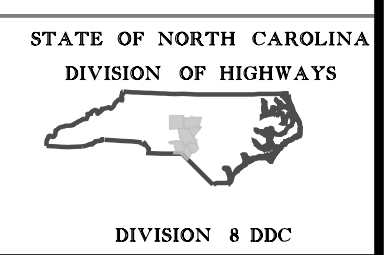

## MANAGEMENT STRATEGIES

- US 421 AND SR 2120 TRAFFIC WILL BE MAINTAINED THROUGH LANE CLOSURES.
- TRAFFIC WILL BE MAINTAINED IN THE EXISTING PATTERN UNTIL MEDIAN AREA AT THE INTERSECTION IS CLOSED FOR CONSTRUCTION. TRAFFIC IS SHIFTED TO THE UTILIZE UPSTREAM AND DOWNSTREAM MEDIAN OPENINGS.

## PHASING

INSTALL WORK ZONE ADVANCE WARNING SIGNS IN ACCORDANCE WITH NCDOT ROADWAY STANDARD DRAWING NO. 1101.01. WHEN NO WORK IS BEING CONDUCTED FOR A PERIOD LONGER THAN ONE WEEK, REMOVE OR COVER ALL ADVANCE WORK ZONE SIGNS, AS DIRECTED BY THE ENGINEER. PRIOR TO STARTING WORK AFTER INACTIVITY, CONTRACTOR SHALL REINSTALL OR UNCOVER SIGNAGE.

**STEP 1:**

USING ROADWAY STANDARD DRAWING NO. 1101.02 (1 OF 19), CONTRACTOR SHALL BEGIN CONSTRUCTION ON -Y1- STA. 11+01 TO 11+94 AND -Y1- STA. 12+51 TO 14+28 INCLUDING THE FINAL LAYER OF SURFACE COURSE, CONCRETE ISLANDS, MARKINGS AND SIGNAGE.

**STEP 2:**

CONTRACTOR SHALL CLOSE MEDIAN CROSSOVER AT -Y1- AND SWITCH TRAFFIC TO RIGHT TURNS ONLY ON TO US 421 (SEE TMP-3)

USING NCDOT STANDARD DRAWING NO. 1101.02 (SHEET 4 OF 19), BEGIN CONSTRUCTION FROM -L- STA. 12+83.23 TO -L- STA. 19+19.10 INCLUDING THE FINAL LAYER OF SURFACE COURSE, CONCRETE ISLANDS, MARKINGS AND SIGNAGE.

**NOTE:**

AT THE END OF EACH WORK DAY, CONTRACTOR SHALL SAFE-UP MEDIAN WIDENING AND CLOSE MEDIAN SHOULDERS USING NCDOT STANDARD DRAWING NO. 1101.04.

**STEP 3:**

REMOVE ALL WORK ZONE TRAFFIC CONTROL DEVICES AND OPEN US 421 (-L-) AND SR 2120 (-Y1-) TO FINAL TRAFFIC PATTERN.

\$\$\$SYTIME\$\$\$\$\$  
 \$\$\$DGN\$\$\$\$\$  
 \$\$\$USERNAME\$\$\$\$\$

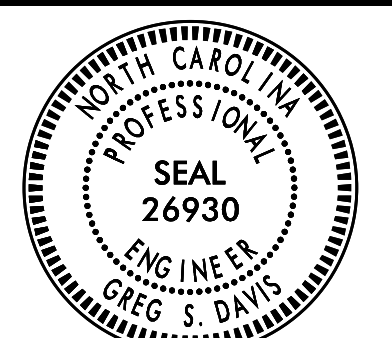
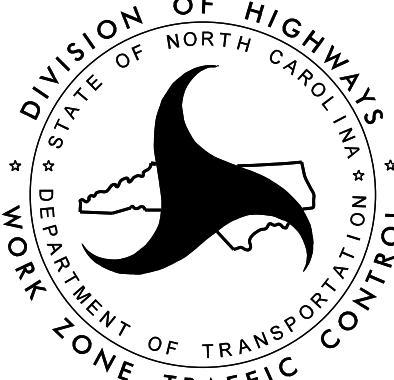
APPROVED: <span style="font-size: small;">DocuSigned by: Greg Davis</span> <span style="font-size: x-small;">330478FD78FAA8</span> DATE: <span style="font-size: x-small;">04/30/2026</span>			<h3 style="margin: 0;">TEMPORARY TRAFFIC CONTROL PHASING</h3>
--	---	---	---

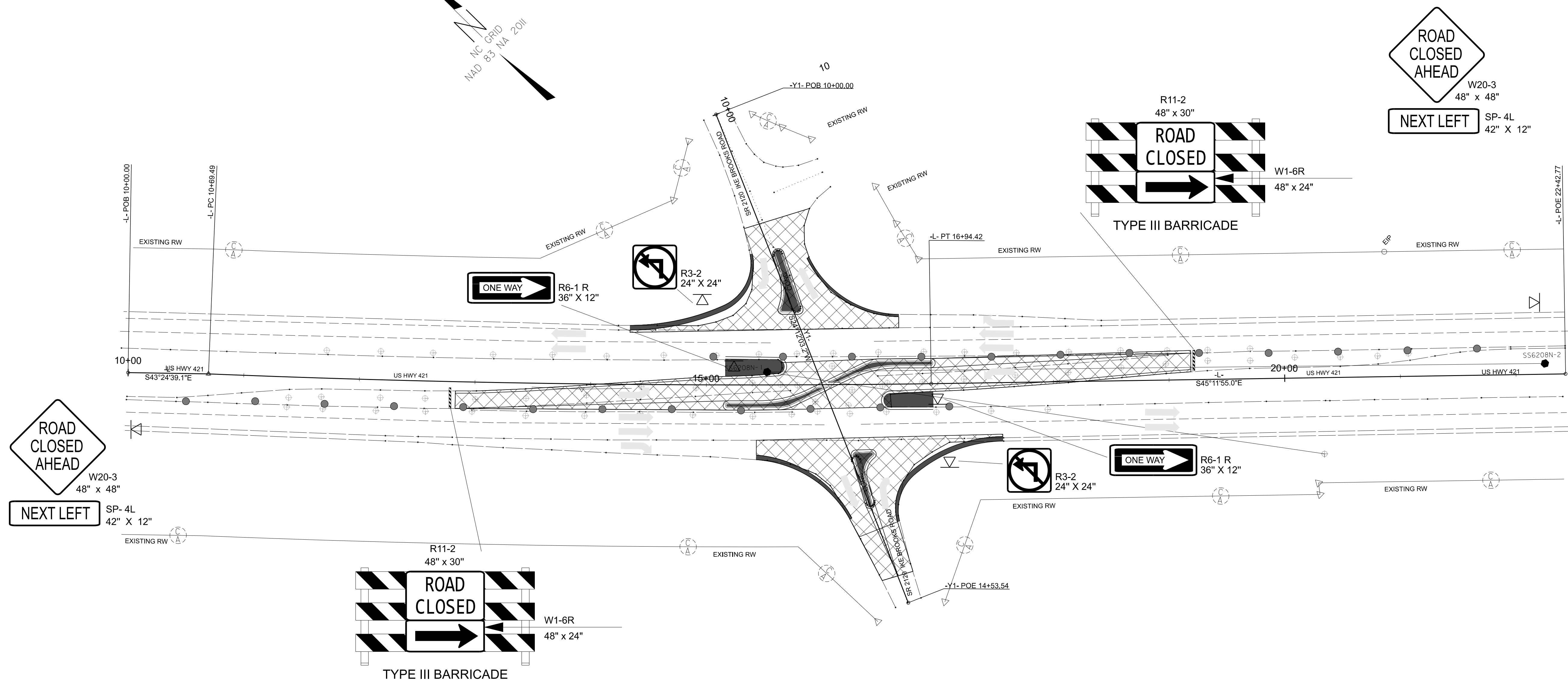
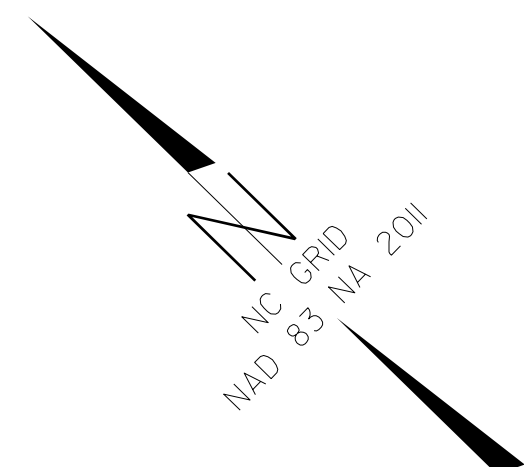

4/30/2026  
 P:\w\ncdot\p\ben\hwy.com\ncdot\p\w\0\Documents\Division\_08\SS-6208N\Work Zone Traffic Control\SS-6208N-TC-TMP  
 User: gsdavis2

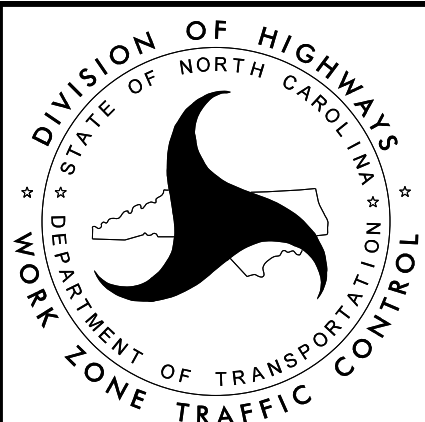
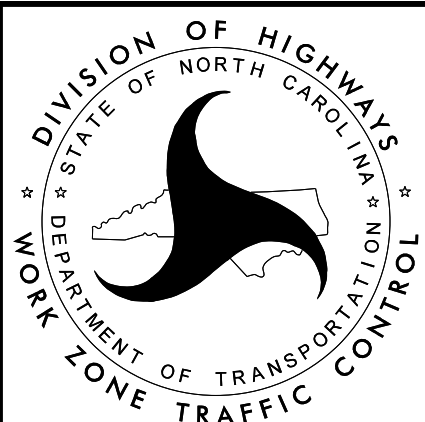
APPROVED: 	DATE: 04/30/2026		<h2 style="text-align: center;">TEMPORARY TRAFFIC CONTROL DETAIL</h2>
			

# STATE OF NORTH CAROLINA DEPARTMENT OF TRANSPORTATION

## PAVEMENT MARKING SCHEDULE CHATHAM COUNTY

LOCATION: INTERSECTION OF US 421 AT SR 2120 (IKE BROOKS RD)

### PAVEMENT MARKING SCHEDULE

<u>SYMBOL</u>	<u>DESCRIPTION</u>
THERMOPLASTIC (6", 90 MILS)	
T20	WHITE EDGELINE
T24	2 FT. - 6 FT./SP WHITE MINISKIP
T30	YELLOW EDGELINE
T31	YELLOW DOUBLE CENTER
T34	2 FT. - 6 FT./SP YELLOW MINISKIP
THERMOPLASTIC (12", 90 MILS)	
T50	WHITE GORELINE
T51	WHITE DIAGONAL
T52	YELLOW DIAGONAL
THERMOPLASTIC (24", 90 MILS)	
T61	WHITE STOPBAR
THERMOPLASTIC (90 MILS)	
T70	LEFT TURN ARROW
T71	RIGHT TURN ARROW

### PAVEMENT MARKING SYMBOLS

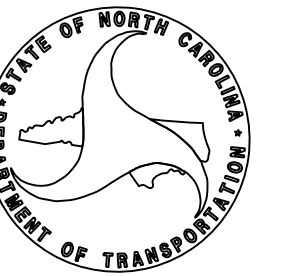
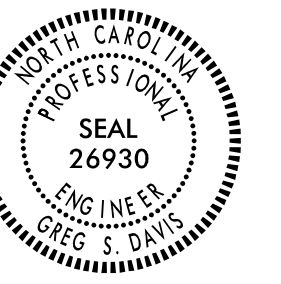

WBS: 51274

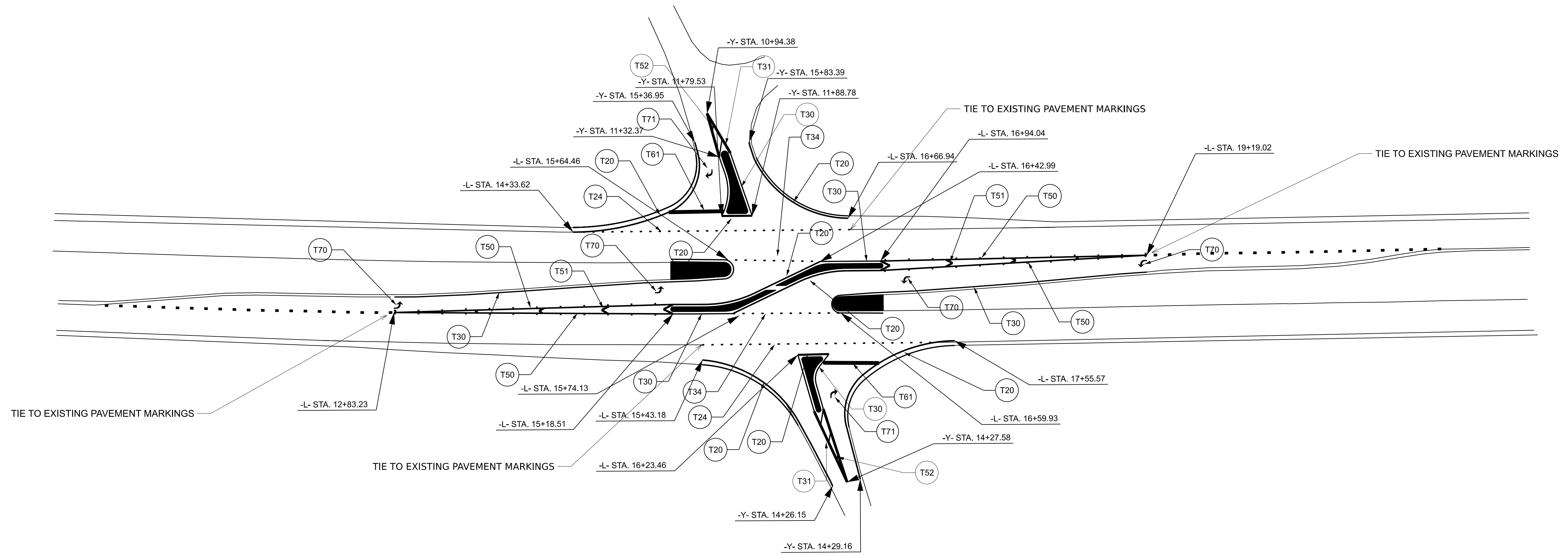
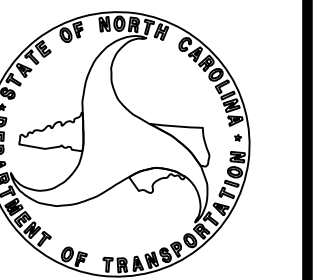

PAVEMENT MARKING PLAN